

CHDSBC Series - Multi-Cartridge Liquid Filter Housings



w/ Swing Bolt Closure

Manufactured of AISI304 or AISI316L stainless steel for high-purity industrial filtration requirements. The flexible design accommodates DOE, 222/FIN, and 222/FLAT style cartridges. They accept standard 2.5" to 2.85"OD filter cartridges in configurations of up to 50-around and up to 40" cartridge length.

This housing series offers a great many options for cartridge quantity, flow rate capacity, and porting. They're the standard choice to support higher flow rate applications with abundant options for cartridge media types and retention ratings.

Features

- Rugged swing-bolt closure allows easy access for cartridge changes.
- Strengthened, welded legs provide a stable and durable installation.
- 150 psi (10 bar) operating pressure rating.
- Davit arm hand wheel features improved ease of operation (12 around and up).
- Can provide flow rates to 1,200 GPM and beyond.

Applications

- Suitable for the broadest range of industrial applications from process fluid streams for water, aqueous solutions, oils, and fine chemicals
- Used in food and beverage production: filtration of juices, syrups, food ingredients, and bottled water

Product Quality

- Manufactured within an ISO 9001:2015 certified quality management system.
- Certification of Quality document can be provided upon request.

Materials of Construction

Shell Components	AISI304 or AISI316L Stainless Steel
Seal Options	EPDM (standard), SILICONE, NBR, FKM

Surface Finish

Surface Quality	Glass beaded finish is standard Industrial electropolish option
-----------------	---

Operating Conditions

Operating Temperature	121°C (250°F) max.
Design Pressure	10 bar (150 psi)

Cartridge Type



Pleated



Melt
Blown



String
Wound



DOE



222/Fin

End Cap

CHDSBC Series - Multi-Cartridge Liquid Filter Housings



Dimensions (mm)

Industrial Cartridge Housing - 5X

Num	Name	Specification	Connection mode
N1	Inlet	FNPT 2"	Thread
N2	Outlet	FNPT 2"	
N3	Vent	FNPT 1/4"	
N4	Gauge	FNPT 1/4"	
N5	Gauge	FNPT 1/4"	
N6	Drain	FNPT 1/2"	

Size	A	B	C	D
10"	430	665	770	120
20"	680	915	1020	247
30"	930	1165	1270	498
40"	1180	1415	1520	746

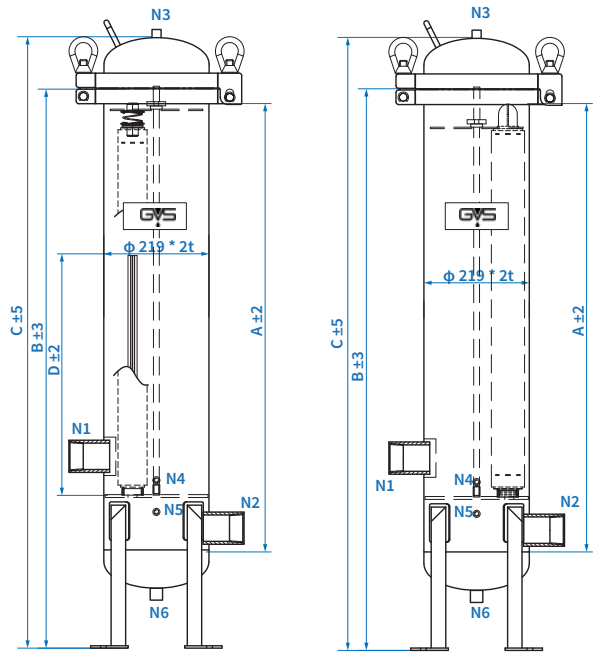
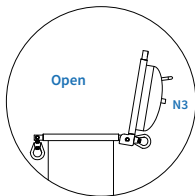
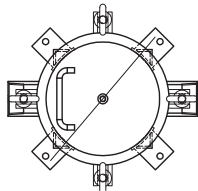

Cartflow

Industrial Cartridge Housing - 7X

Size	A	B	C	D
10"	450	700	820	120
20"	700	950	1070	247
30"	950	1200	1320	498
40"	1200	1450	1570	746

Num	Material	Name	Specification	Connection mode
N1	304	Inlet	FNPT 2"	Thread
	316L	Outlet	WN50-150RF	Flange
N2	304	Inlet	FNPT 2"	Thread
	316L	Outlet	WN50-150RF	Flange
N3	304/316L	Vent	FNPT 1/4"	Thread
N4		Gauge	FNPT 1/4"	
N5		Gauge	FNPT 1/4"	
N6		Drain	FNPT 1/2"	

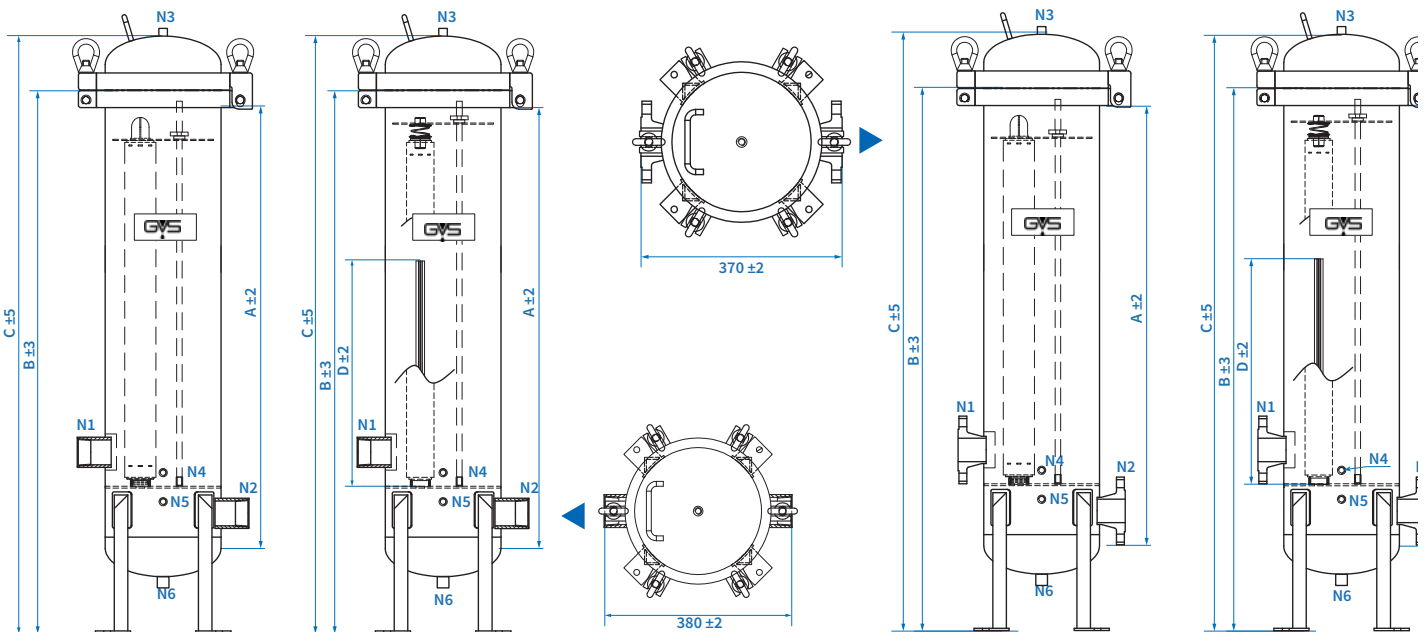

Dimensions (mm)

Industrial Cartridge Housing - 12X

Num	Name	Specification	Connection mode
N1	Inlet	FNPT 2"	Thread
N2	Outlet	FNPT 2"	
N3	Vent	FNPT 1/4"	
N4	Gauge	FNPT 1/4"	
N5	Gauge	FNPT 1/4"	
N6	Drain	FNPT 1/2"	

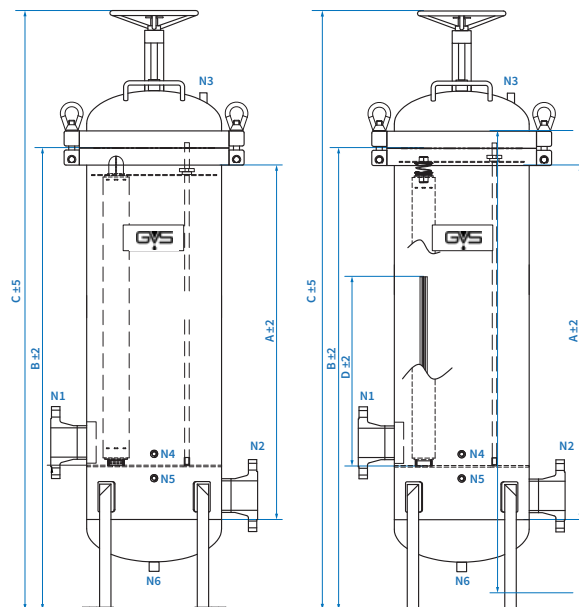

Industrial Cartridge Housing - 7X

Size	A	B	C	D
10"	430	665	770	120
20"	680	915	1020	247
30"	930	1165	1270	498
40"	1180	1415	1520	746

Eg.=>CHDSBC4120N304SEP

ORDERING INFORMATION												
Series	Ctg Qty		Cartridge Length		Main Ports		Material		Seals		Option, Standard	
CHDSBC	4	4 Cartridges	1	10"	20N	2"FNPT	304	AISI304	E	EPDM	EP	Electropolished
	5	5 Cartridges	2	20"	30N	3"FNPT	316L	AISI316L	B	NBR		
	7	7 Cartridges	3	30"	20F	2"RF FLANGE			S	Silicone		
	12	12 Cartridges	4	40"	30F	3"RF FLANGE			V	FKM		
	21	21 Cartridges			40F	4"RF FLANGE						
	36	36 Cartridges			60F	6"RF FLANGE						
	51	51 Cartridges										